

YK180XC

Note. Built-to-order product. Contact us for the delivery period.

- Arm length 180mm
- Maximum payload 1kg

■ Ordering method

YK180XC - 100

Model	Z axis stroke	Cable length
	100: 100mm	3L: 3.5m
		5L: 5m
		10L: 10m

RCX340-4

Controller / Number of controllable axes	Safety standard	Option A (OP.A)	Option B (OP.B)	Option C (OP.C)	Option D (OP.D)	Option E (OP.E)	Absolute battery
---	------------------------	------------------------	------------------------	------------------------	------------------------	------------------------	-------------------------

Specify various controller setting items. RCX340 ▶ **P.542**

RCX240S

Controller	CE Marking	Expansion I/O	Network option	iVY System	Gripper	Battery
-------------------	-------------------	----------------------	-----------------------	-------------------	----------------	----------------

Specify various controller setting items. RCX240/RCX240S ▶ **P.532**

■ Basic specifications

	X axis	Y axis	Z axis	R axis
Axis specifications				
Arm length (mm)	71	109	100	-
Rotation angle (°)	+/-120	+/-140	-	+/-360
AC servo motor output (W)	50	30	30	30
Repeatability ^{Note 1} (XYZ: mm) (R: °)	+/-0.01		+/-0.01	+/-0.004
Maximum speed (XYZ: m/sec) (R: °/sec)	3.3		0.7	1700
Maximum payload (kg)	1.0			
Standard cycle time: with 0.1kg payload ^{Note 2} (sec)	0.42			
R-axis tolerable moment of inertia ^{Note 3} (kgm ²)	0.01			
User wiring (sq × wires)	0.1 × 8			
User tubing (Outer diameter)	φ3 × 2			
Travel limit	1.Soft limit, 2.Mechanical limit (X, Y, Zaxis)			
Robot cable length (m)	Standard: 3.5 Option: 5, 10			
Weight (kg) (Excluding robot cable) ^{Note 4}	6.5			
Robot cable weight	1.5kg (3.5m) 2.1kg (5m) 4.2kg (10m)			
Degree of cleanliness	CLASS 10 (0.1 μm base)			
Intake air (Nℓ/min)	30			

■ Controller

Controller	Power capacity (VA)	Operation method
RCX340 RCX240S	500	Programming / I/O point trace / Remote command / Operation using RS-232C communication

Note. "Harmonic" and "Harmonic drive" are the registered trademarks of Harmonic Drive Systems Inc.

Note 1. This is the value at a constant ambient temperature. (X,Y axes)
 Note 2. When moving 25mm in vertical direction and 100mm in horizontal direction reciprocally.
 Note 3. There are limits to acceleration coefficient settings.
 Note 4. The total robot weight is the sum of the robot body weight and the cable weight.

YK180XC

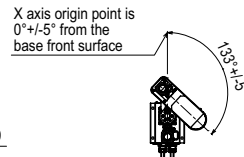
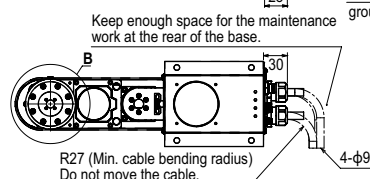
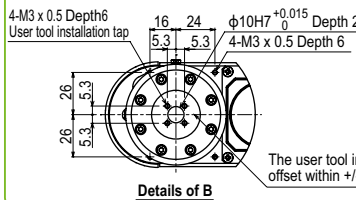
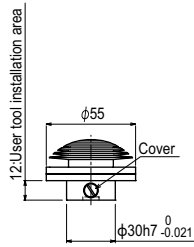
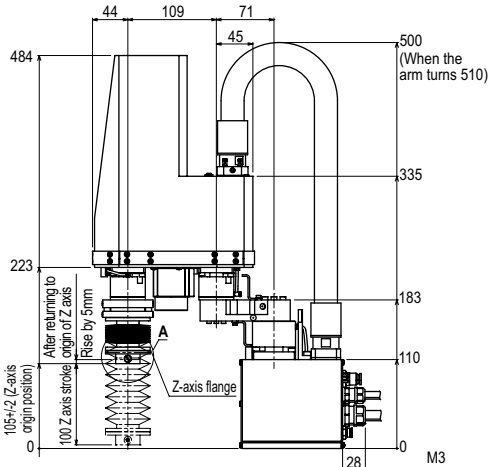
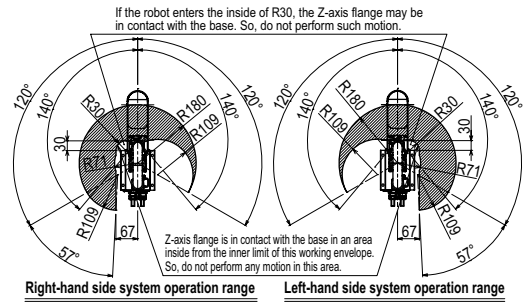
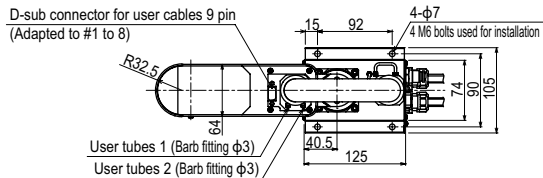

X-axis and Y-axis origin positions

Move counterclockwise in advance from the above position when performing origin return.

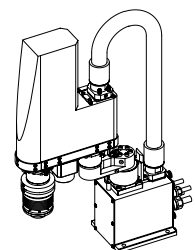

- Articulated robots
- VA
- Linear conveyor modules
- LCM100
- Compact
- TRANSEVO
- Single-axis robots
- FLIP-X
- Linear motor
- PHASER
- Cartesian robots
- XY-X
- SCARA robots
- YK-X
- Pick & place robots
- YP-X
- CLEAN
- CONTROLLER INFORMATION
- Single-axis
- Cartesian
- SCARA